

## MASTER BEDROOM

A tongue-and-groove panelled floating wall creates space for a walk-in wardrobe behind. Varying tones of contemporary grey paint – Vintage Chandelier and Perfectly Taupe, both by Dulux – add depth and soften the overall look. Throws and cushions, House Envy. Faux fur blanket, John Lewis



Real Homes  
CASE STUDY

*‘The wardrobe is part of the bedroom without detracting from the space’*



## THE OWNERS

Emma Boulton, a research director, and husband Mark, a design director (both right), live here with their daughters Alys, eight, and Nansi, five

## THE PROPERTY

An extended four-bedroom farmworkers' cottage built in the late 18th century in Llantwit Major, Vale of Glamorgan

## EMMA LOVES

The Swiss Alps  
Mark's homemade Okonomiyaki  
The store House Envy  
VW campervans  
Nordic Noir TV dramas  
The colour blue  
A whiskey Old Fashioned

## SUBTLE SHOWCASE

Below Recessed shelving provides space for a television and ornaments without impacting the design of the room. Sculpture, Bill Gordon



# SCANDI-STYLE MAKEOVER FOR A MASTER SUITE

A memorable hotel stay inspired Emma and Mark Boulton when it came to creating their own bedroom sanctuary

WORDS & STYLING NICOLA WILKES PHOTOGRAPHS MATT CANT

When Mark and I started thinking about redecorating our master bedroom and en suite, we hadn't really considered what could be possible in terms of changing the layout or design style,' says Emma. Having already tackled the modernisation of their kitchen, utility, dining room and snug, as well as updating their daughters' bedrooms, the master suite was the finishing touch in renovating their four-bedroom cottage.

Luckily for the Boultons, the previous owners had extended the cottage to create a generous en suite and master bedroom. 'They provided a good skeleton on which to build,' says Emma. 'It just wasn't to our taste.'

The couple had redecorated the rest of the house themselves, but decided to call in some extra help with the master suite. 'We started looking online for local companies and found Dorian and Babette Bowen of Project One,' says Mark. 'We were drawn to them as we felt they knew how to combine a modern design with a period property.'

The designers provided the couple with plenty of ideas for reconstructing the space, drawing on the Boultons' memories of a hotel in Geneva that they'd stayed in. 'It had wonderfully simple rooms, and they worked so well,' recalls Mark. 'Plus, we both love Scandinavian design, so that was a heavy influence for the colours and accessories.'

They settled on a spa-like bathroom, and layered up the bedroom with different textures and styles, such as panelling, and plenty of cushions, throws and rugs. ➤



#### WALK-IN WARDROBE

**Left** The storage area has hanging space on one side, and drawers and shelving on the other, and was custom made to match the en suite furniture

#### EXISTING EN SUITE

**Below** The bathroom to the master bedroom was already in place but didn't match Mark and Emma's vision of a sleek, spa-like experience



BEFORE



AFTER

One of the couple's requirements was to somehow include a walk-in wardrobe. Project One worked with sketches of Mark's initial concepts, concealing the hanging space behind a floating wall. 'We loved the idea of making this part of the bedroom without detracting from the space or spoiling the view of the surrounding countryside,' he says. The dark oak of the wardrobe fixtures and fittings brings warmth and depth to the space, while vintage-style wall lights on either side of the bed add an extra dimension. 'Design details, such as the tongue-and-groove panelling and back-lit wall, really bring it to life,' he adds.

The couple decamped to the spare bedroom for four months while the work was carried out. 'It didn't affect us too much,' says Emma. 'We'd saved up to complete the project so once we found the right designers, it simply took time to get the level of finish and detail we wanted for the budget - we focused a lot on materials.' The Italian, two-person stone bath was their most indulgent purchase. 'It was pricey,' she admits. 'The floor needed reinforcing to take its weight. We always knew there would be one item we had to decide to go for or not, and this was it.'

The en suite is not only functional but supremely luxurious. 'We love that everything works and nothing has been added without purpose,' says Emma. 'The wall-mounted tall boy and vanity unit are great for storage, and the rainfall shower was a must. But the bath is the main focal point. There is nothing quite like relaxing in the tub, listening to music on the Sonos surround-sound system.'

Emma and Mark credit Project One with pushing them to go for something different. 'Even though we both love design and know what we're doing most of the time, we're so glad we didn't attempt this on our own. We had just got to that point where we wanted some fresh ideas and someone to say "Have you thought of this?"' Dorian and Babette raised the bar in terms of style and aesthetics for us, and we couldn't be happier with the end result. 🍷

#### NEW SHOWER

**Below** A semi-frameless Simpsons glass screen and Revive shower, both by Crosswater, offer a rainfall experience. The wall-mounted tall boy by Project One is Xylocleaf, like the wardrobe

#### LUXURY BATH

**Right** The Picasso bath by Lusso has a Crosswater Mike Pro bath/shower mixer. Toulouse basin, Victorian Plumbing. Abacus Vessini Opaz WC, Plumb Nation. Limestone floor, Mandarin Stone



*'The bath is the main focal point. The floor needed reinforcing to take its weight'*

BEFORE



#### STORAGE SOLUTION

Although the previous homeowners had extended the property to make room for the master suite, the idea for the floating wall came from Project One's design team

AFTER

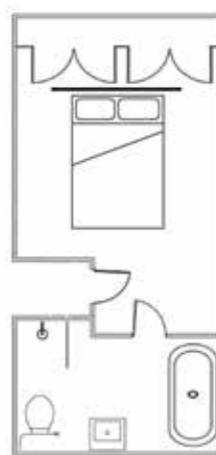

#### THE COSTS AND CONTACTS

Building work  
**£12,000**

Bath  
**£5,500**

Tiles and flooring  
**£4,200**

Wardrobes  
**£3,000**

Sink and taps  
**£2,000**

Lighting  
**£1,200**

Accessories  
**£900**

Bed  
**£800**

Furniture  
**£400**

TOTAL  
**£30,000**

Design Project One,  
029 2140 6283,  
projectonewales.co.uk  
Flooring Mandarin Stone  
Brassware Crosswater